



Author: Sharon Wilkings  
File / Ref number: Drainage Reserves GRC:SW  
Directorate / Unit: State Land Asset Management  
Phone: (07) 49384577

23 December 2010

Mr Graeme Kanofski  
The Chief Executive Officer  
Gladstone Regional Council  
PO Box 29  
GLADSTONE QLD 4680

GLADSTONE REGIONAL COUNCIL RECORDS DEPT	
Resp Officer/s	Greg Winter
04 JAN 2011	
Ret.....	Doc No.....
File Ref	GRC.2 R 120231

P 46907

R 120237  
R 120238  
R 120233  
R 120232  
R 120236

Dear Mr Kanofski

**PROPOSED ALLOCATION OF UNALLOCATED STATE LAND IN TANNUM SANDS AS RESERVE FOR DRAINAGE PURPOSES**

The department has identified various parcels of unallocated State land in Tannum Sands as drainage areas and therefore the most appropriate tenure for the land is considered to be reserve for drainage purposes with council as trustee.

I have enclosed a list of the lot and plan descriptions of the subject parcels for your information and a SmartMap of the area.

Native title may continue to exist over this land. Section 24KA of the *Native Title Act* allows facilities for service to the public to be established, for the benefit of the community as a whole, for a drainage facility. Under Section 24KA, established means the construction, operation, use, maintenance or repair of a facility on behalf of the Crown, local government body or statutory authority of the Crown in any of its capacities, of particular facilities.

Should council accept trusteeship of the land, the department will notify the relevant Registered Native Title Claimants and Registered Native Title Body Corporate for the particular area, of the State's intention to dedicate the land as reserve for drainage purposes.

Would you please advise, in writing, if Council is prepared to accept trusteeship of reserves for drainage purposes over these parcels.

Section 44 (2) of the *Land Act 1994* states:  
A trustee may be –

- (a) the State; or
- (b) a statutory body; or
- (c) an incorporated body; or
- (d) a named individual

Office :  
DERM Rockhampton  
Level 1, State Government Centre  
209 Bolsover Street  
Rockhampton QLD 4700

Postal :  
DERM Rockhampton  
PO Box 1762  
Rockhampton  
4700 QLD

Telephone : (07) 49384577  
Fax: (07)49384800

If council has identified any other areas of land as drainage areas, please advise the department and the land will be assessed and allocated as reserve for drainage purposes if appropriate.

Please quote the reference 'Drainage Reserves GRC:SW' in any future correspondence.

If you wish to discuss this matter further please contact me on (07) 49384577 or by email to [SLAM-Rockhampton@derm.qld.gov.au](mailto:SLAM-Rockhampton@derm.qld.gov.au).

Yours sincerely

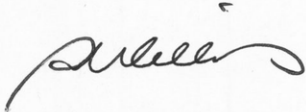

Sharon Wilkings  
Land Officer – Property Services  
Rockhampton

Att: Drainage areas – Tannum Sands

**DRAINAGE AREAS – TANNUM SANDS**

<b>No.</b>	<b>Lot/Plan No.</b>	<b>Area (ha)</b>	<b>Description of land</b>
1	21/T82810	0.0299	Coral Street, Tannum Sands
2	5/T82827	0.2008	Neptune Street, Tannum Sands
3	20/T82813	0.1507	Neptune Street, Tannum Sands
4	49/T82815	0.0562	Neptune Street, Tannum Sands
5	51/T82815	0.0268	Creek Road, Tannum Sands
6	52/T82815	0.0225	Trevally Street, Tannum Sands
7	10/T82814	0.0653	Seaview Street, Tannum Sands
8	30/T82816	0.0700	Elizabeth Street, Tannum Sands
9	1/AP14770	0.0800	Elizabeth Street, Tannum Sands
10	1/AP11345	0.1200	Pacific Avenue, Tannum Sands
11	2/AP14769	0.3900	Trevally Street, Tannum Sands

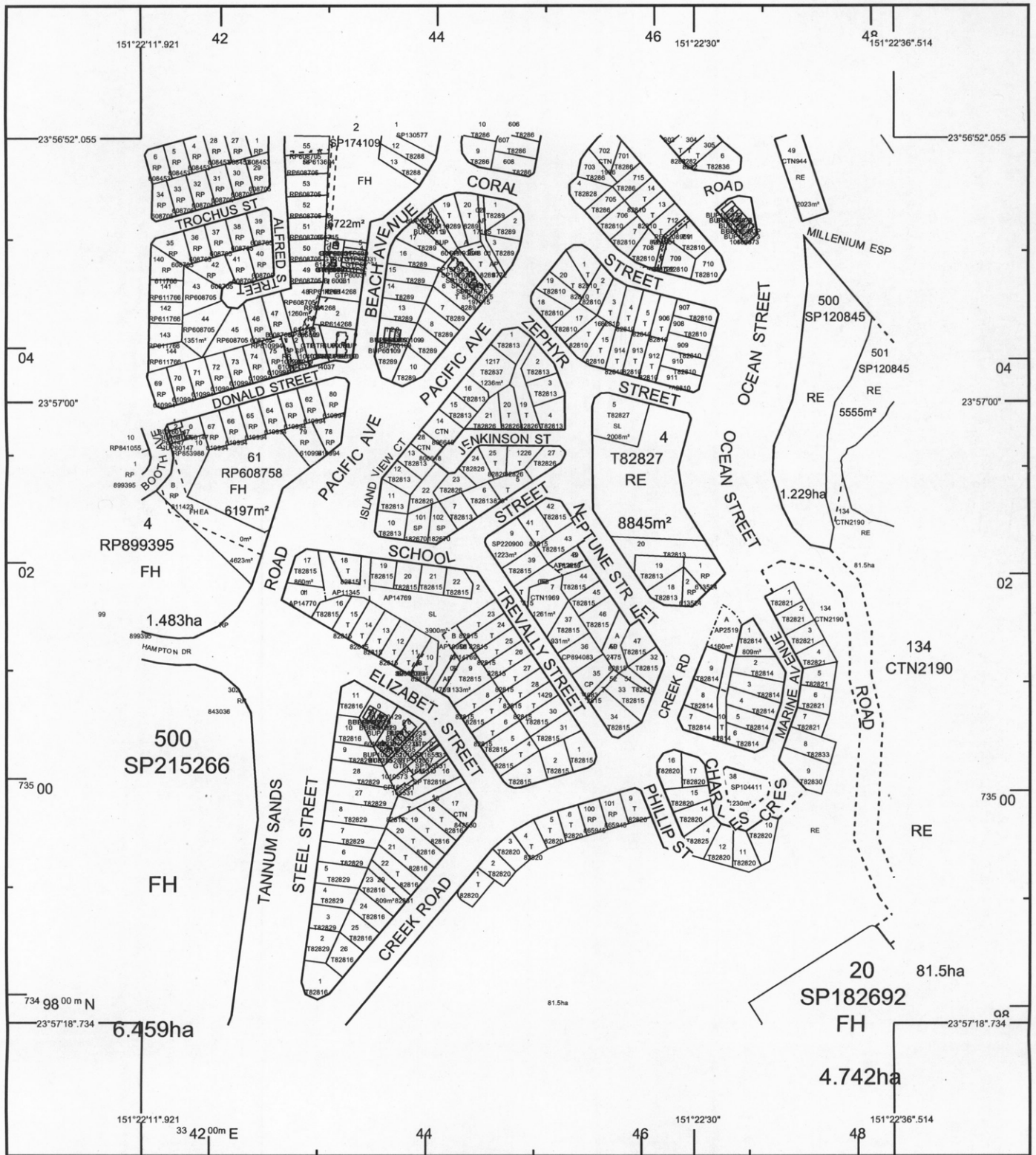

STANDARD MAP NUMBER  
9150-23211

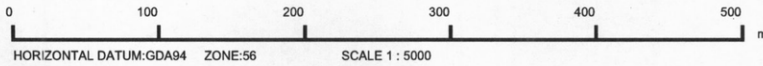

MAP WINDOW POSITION & NEAREST LOCATION



**SUBJECT PARCEL DESCRIPTION**

DCDB	No Lot/Plan Selected.
Lot/Plan	No Lot/Plan Selected.
Area/Volume	No Lot/Plan Selected.
Tenure	No Lot/Plan Selected.
Local Government	No Lot/Plan Selected.
Locality	No Lot/Plan Selected.
Parish	No Lot/Plan Selected.
County	No Lot/Plan Selected.
Segment/Parcel	No Lot/Plan Selected.

**CLIENT SERVICE STANDARDS**

PRINTED (dd/mm/yyyy) 23/12/2010

DCDB 22/12/2010

Users of the information recorded in this document (the Information) accept all responsibility and risk associated with the use of the Information and should seek independent professional advice in relation to dealings with property.

Despite Department of Environment and Resource Management (DERM)'s best efforts, DERM makes no representations or warranties in relation to the Information, and, to the extent permitted by law, exclude or limit all warranties relating to correctness, accuracy, reliability, completeness or currency and all liability for any direct, indirect and consequential costs, losses, damages and expenses incurred in any way (including but not limited to that arising from negligence) in connection with any use of or reliance on the Information

For further information on SmartMap products visit <http://nrw.qld.gov.au/property/mapping/blnmap>

**SmartMap**

An External Product of SmartMap Information Services

Based upon an extraction from the Digital Cadastral Data Base



**Queensland Government**

(c) The State of Queensland, (Department of Environment and Resource Management) 2010.

